



Titian Avenue, Bushey Heath

£495,000

Cosway are excited to offer this unique and charming two-bedroom character cottage, ideally situated in a sought-after residential location off Elstree Road in Bushey Heath.

The home features a spacious lounge and dining room, a beautiful modern fully fitted kitchen, a separate utility room, two well-proportioned bedrooms, and a family bathroom on the first floor.

Outside, there is a well-maintained garden and a lovely outhouse with air-conditioning perfect for use as a home office, gym, or summer house. Additionally, the property benefits from a private driveway with space for one car and an electric vehicle charging point.

Just 1/4 mile from Bushey High Street, the property offers easy access to buses, shops, schools, churches, and synagogues. This is a fantastic opportunity to own a distinctive home in a prime location. Sole Agent. Chain Free.

Viewing

Please contact our Mill Hill Office on 02089590011 if you wish to arrange a viewing appointment for this property or require further information.

- Character Terraced Cottage
- Kitchen/breakfast room
- Lounge/dining room
- Two Spacious Double Bedrooms
- Rear garden
- Off street parking
- Close To Amenities
- Excellent Local Schools
- Chain Free



Floor Plan

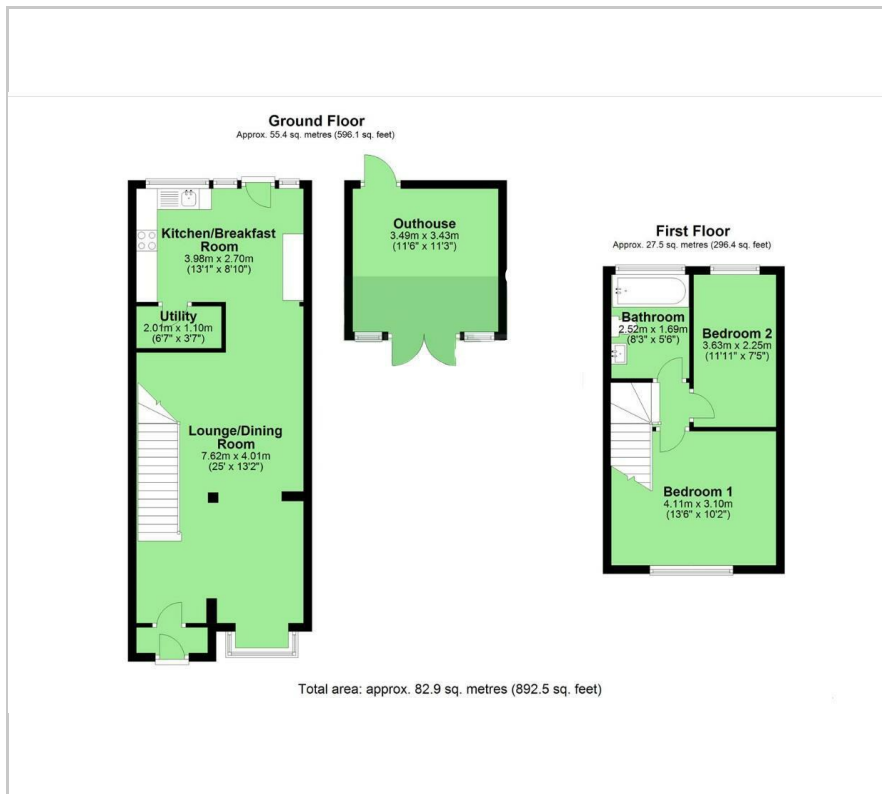

Area Map



Energy Efficiency Graph

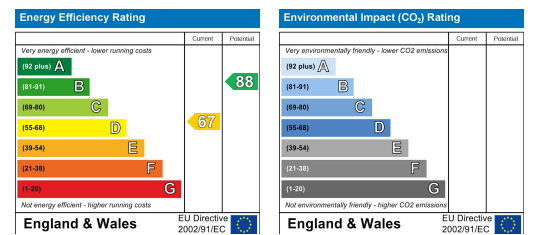

These particulars, whilst believed to be accurate are set out as a general outline only for guidance and do not constitute any part of an offer or contract. Intending purchasers should not rely on them as statements of representation of fact, but must satisfy themselves by inspection or otherwise as to their accuracy. No person in this firm's employment has the authority to make or give any representation or warranty in respect of the property.